

OREGON PUBLIC LAND CORNER REPORT / RESTORATION REPORT
Tillamook County Surveyor's Office

| | | |
|--|--------------------------|---|
| SECTION: 17 and 20 | TOWNSHIP: 1 South | RANGE: 9 West |
| COUNTY: Tillamook | | DATE: 4/2022 |
| CORNER DESIGNATION: Quarter Corner common to Sections 17 and 20, Township 1 South, Range 9 West; Willamette Meridian. | | (Please check one) |
| | | <input checked="" type="checkbox"/> Condition Report Only |
| | | <input type="checkbox"/> Restoration |
| | | <input type="checkbox"/> Rewitness |
| | | <input type="checkbox"/> Unrecorded |
| | | <input type="checkbox"/> Reset at surface |
| | | <input type="checkbox"/> Referenced Out |

Previous Rewitnesses, Restorations and Surveys, etc... A-2028 (1970), A-3003 (1976), A-5301 (1985), B-535 (1967), B-1665 (1989), B-1794 (1994), B-3578 (2013), P-1075 (2016), GLO PG. 68 (1857), Rewitness Bk. 1 pg. 80 (1949), Rewitness Bk. 4 pg. 55 (1949), Rewitness Card # 202 (1969)

History, condition, and sources:
 In 1857 Henry Meldrum while under contract for the General land office set a post for the South quarter of Section 17 and referenced the corner with 2 bearing trees. In 1949 (Rewitness Bk. 1 pg. 80) W.E. Anderson reset the ¼ corner by subdivision between the two section corners with a 3" iron pipe and referenced the corner with 2 bearing trees. In 1967 (B-535) while breaking down section 17 Harold Russell Found a 2 ½" Iron pipe for the corner. In 1969 (Rewitness card #202) the Tillamook County Survey Office found a 1 ½" iron pipe with a tack which they set a 2" iron pipe with a Tillamook County brass cap stamped as shown hereon over the top of the existing monument and added two more references. In 2022 The Tillamook County Surveyors office found the corner 2' below the surface of the field in good condition and stamped as shown hereon.

Not Found: (Rewitness card #202) 36" Maple S 65° E 110.60'
 Found: (Rewitness card #202) 60" Spruce North 111.66'
 Not Found: (Rewitness card #202) 96" Hat Section post with yellow metal location tag North 25'

New accessories set:
 Installed hat section post with yellow metal location tag North 66° West 50.2' in East-West Fence.

The Monument was tied directly using G.P.S. established control. The coordinates have been converted and are provided here in WGS 84, Latitude and Longitude.

Latitude: 45° 28' 40"
 Longitude: - 123° 48' 48"

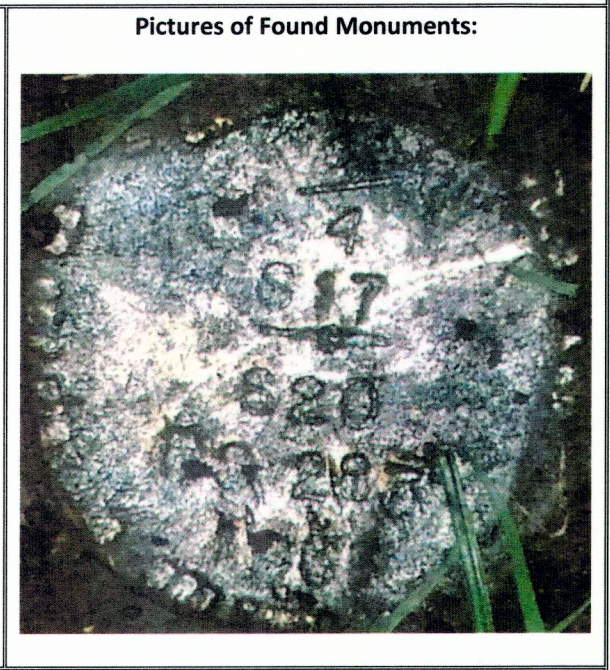

Location: West ±1750' on Latimer Rd. from the intersection of Wilson River Hwy then South ±75' from centerline of pavement in field.

Tillamook County Surveyor office: 1510 3rd Street Suite C, Tillamook, OR. 97141

Party Chief: Terry Jones, P.L.S. 2507, Survey Supervisor

Witnesses: Michael Rice, P.L.S. 86926, Tillamook County Surveyor
 Travis Porter, Survey Tech.

Notes: Digital images taken of monument and accessories.

SURVEYOR'S SEAL

REGISTERED
PROFESSIONAL
LAND SURVEYOR

Terry J. Jones

OREGON
JULY 25, 1991
TERRY L. JONES
2507

RENEWAL DATE: JUNE 30, 2023

